



CONTEST INFORMATION

Marina High School Band

Location: Marina High
15871 Springdale St.
Huntington Beach, 92649

CrossStreets: 405 Freeway/Goldenwest Springdale an

PracticeAreas: Football Field, Tennis Courts, Soccer Fields

TimePracticeAvble: All day?

TimeConcessionsAvble: All Day

Awards: 1st - 3rd Trophy/ Participat

PrimaryContact: John McGilligan PrimaryPhone: 714-893-6571
PrimaryEmail: jmcgilligan@marinavikings.org

SecondaryContact: Jorggi Delane SecondaryPhone: 714-717-2865
SecondaryEmail: jmcgilligan@marinavikings.org

HospitalName: Huntington Beach Hospital
HospitalAddress: 17772 Beach Blvd
HospitalCity: Huntington Beach,

SpecialInstructions:

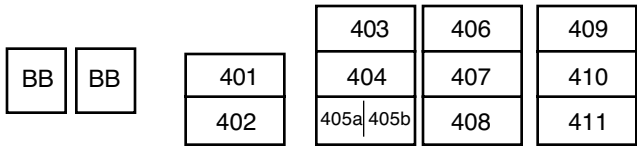

MARINA HIGH SCHOOL
 15871 SPRNGDALE STREET
 HUNTINGTON BEACH, CA 92649
 (714) 893-6571

Map Not To Scale
 Last Updated 1/23/2008

301/302 - Activites office
 324 - Supervision office

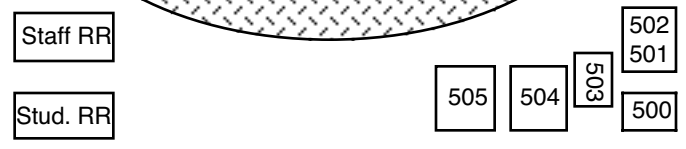
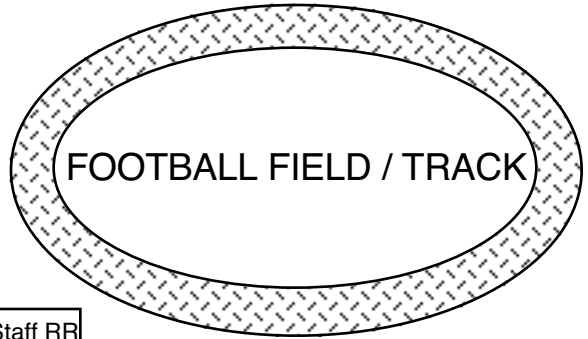
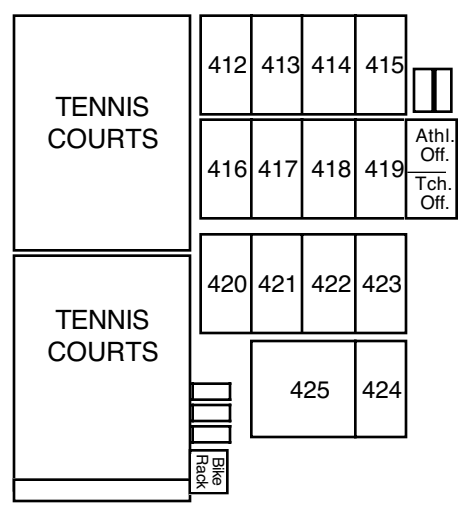

MARINA VIKING WAY

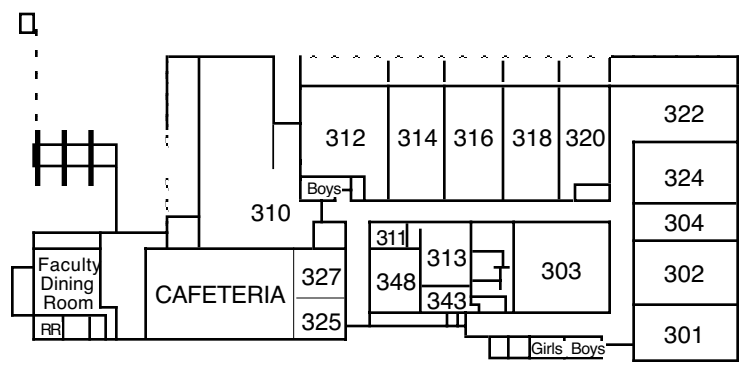
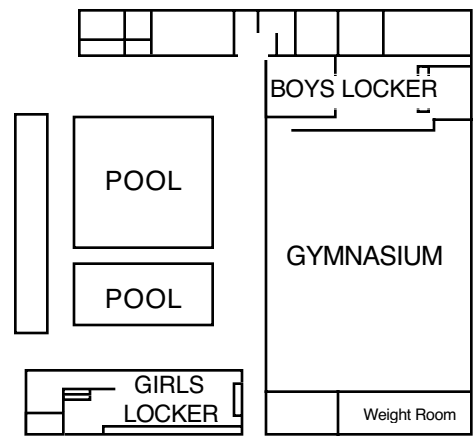

SPRINGDALE ST.

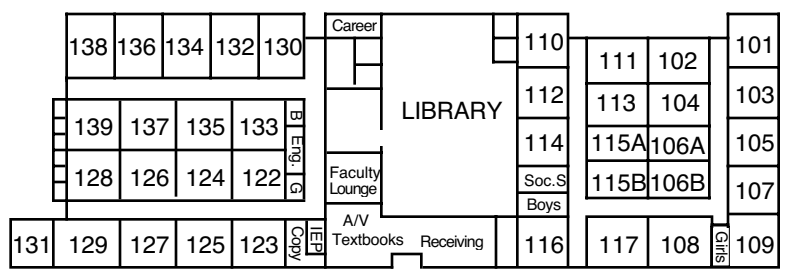
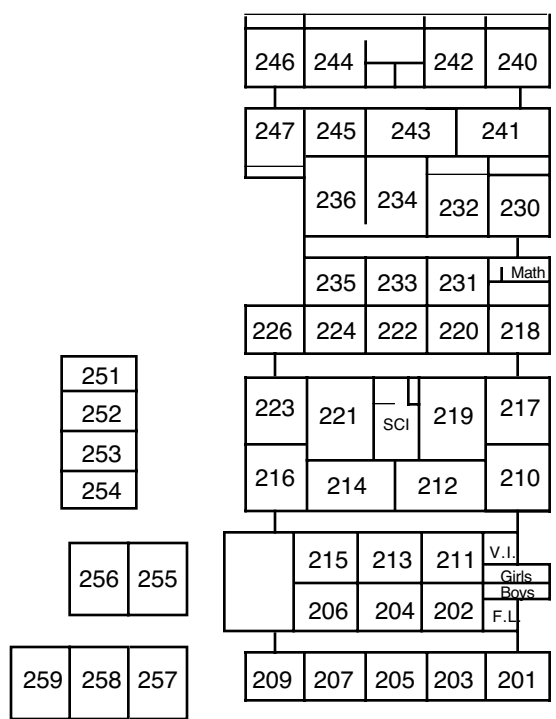
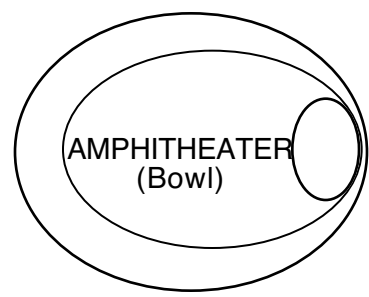

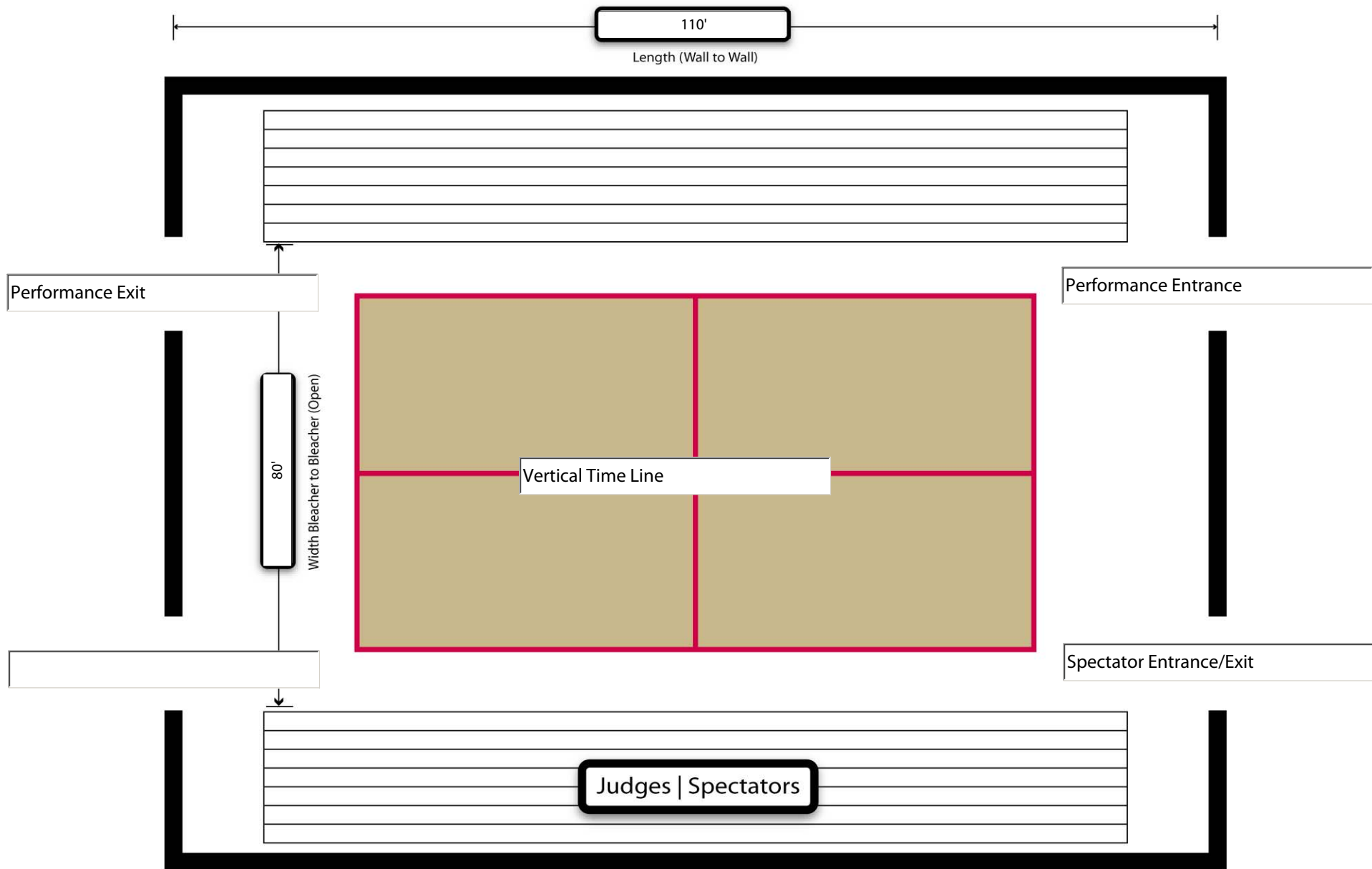

Please enter Gym Length (Wall to Wall), Width (Open Bleacher to Open Bleacher).

Select the appropriate box for each Entrance/Exit and Timing line.

Enter School/Site Information

Site Name

Phone Number

Address

Zip Code



Visitor

Participant

Visitor and Participant Entrance

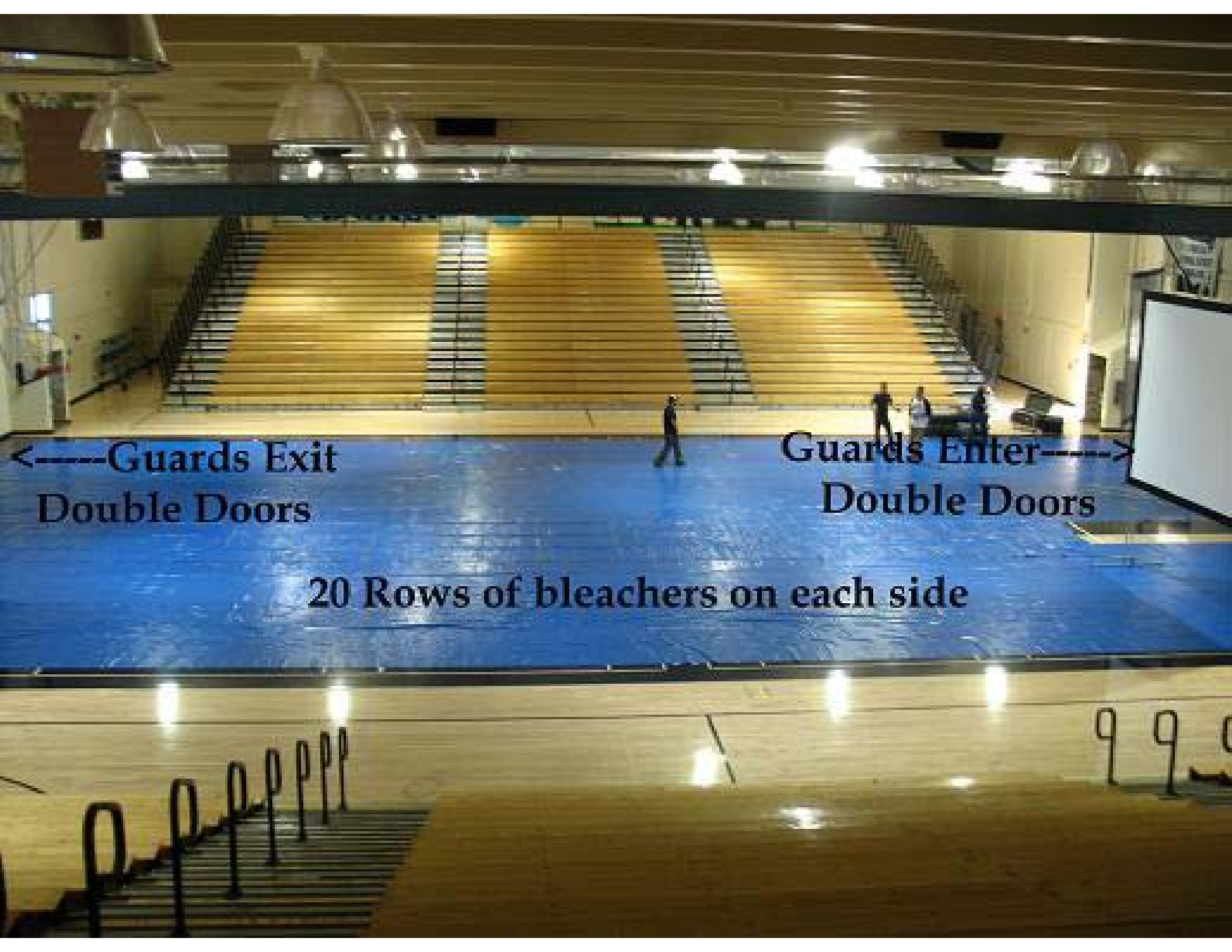

← Guards Exit
Double Doors

Guards Enter →
Double Doors

20 Rows of bleachers on each side

999



Participant Exit

Judges and Audience view



Participant View from floor
Looking to judges



Potential Vendor Area